

**RUSH
WITT &
WILSON**



**28 Woodspring Close, St. Leonards-On-Sea, TN37 7LT
Offers In Excess Of £230,000 Freehold**

Nestled in the charming area of Woodspring Close, this delightful two bedroom end of terrace house presents an excellent opportunity for first-time buyers. The property boasts a well-proportioned living room and a kitchen/diner on the ground floor, providing a comfortable space for relaxation and entertaining. Upstairs, you will find two inviting bedrooms, perfect for rest and rejuvenation, along with a conveniently located bathroom. The house benefits from an allocated parking space, ensuring ease of access for you and your guests. One of the standout features of this property is the good-sized rear garden, which offers a wonderful outdoor space for gardening, play, or simply enjoying the fresh air. While some modernisation is required, this presents a fantastic chance to personalise the home to your taste and style. The location is particularly advantageous, with excellent schooling options nearby and the Conquest Hospital just a short distance away, making it ideal for families and professionals alike. Additionally, the property is chain-free, allowing for a smooth and straightforward purchase process. In summary, this end of terrace house in Woodspring Close is a promising prospect for those looking to step onto the property ladder in a desirable area. With its potential for modernisation and convenient location, it is not to be missed.







RUSH
WITT &
WILSON



RUSH
WITT &
WILSON



RUSH
WITT &
WILSON



RUSH
WITT &
WILSON



Floor 0

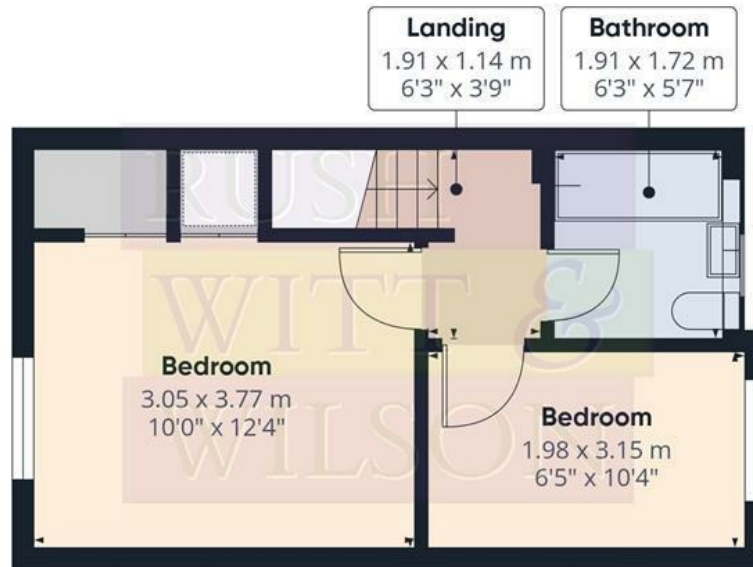

Floor 1



Approximate total area⁽¹⁾

53.4 m²

576 ft²

Reduced headroom

0.6 m²

6 ft²

(1) Excluding balconies and terraces

Reduced headroom

----- Below 1.5 m/5 ft

Calculations reference the RICS IPMS 3C standard. Measurements are approximate and not to scale. This floor plan is intended for illustration only.

GIRAFFE360

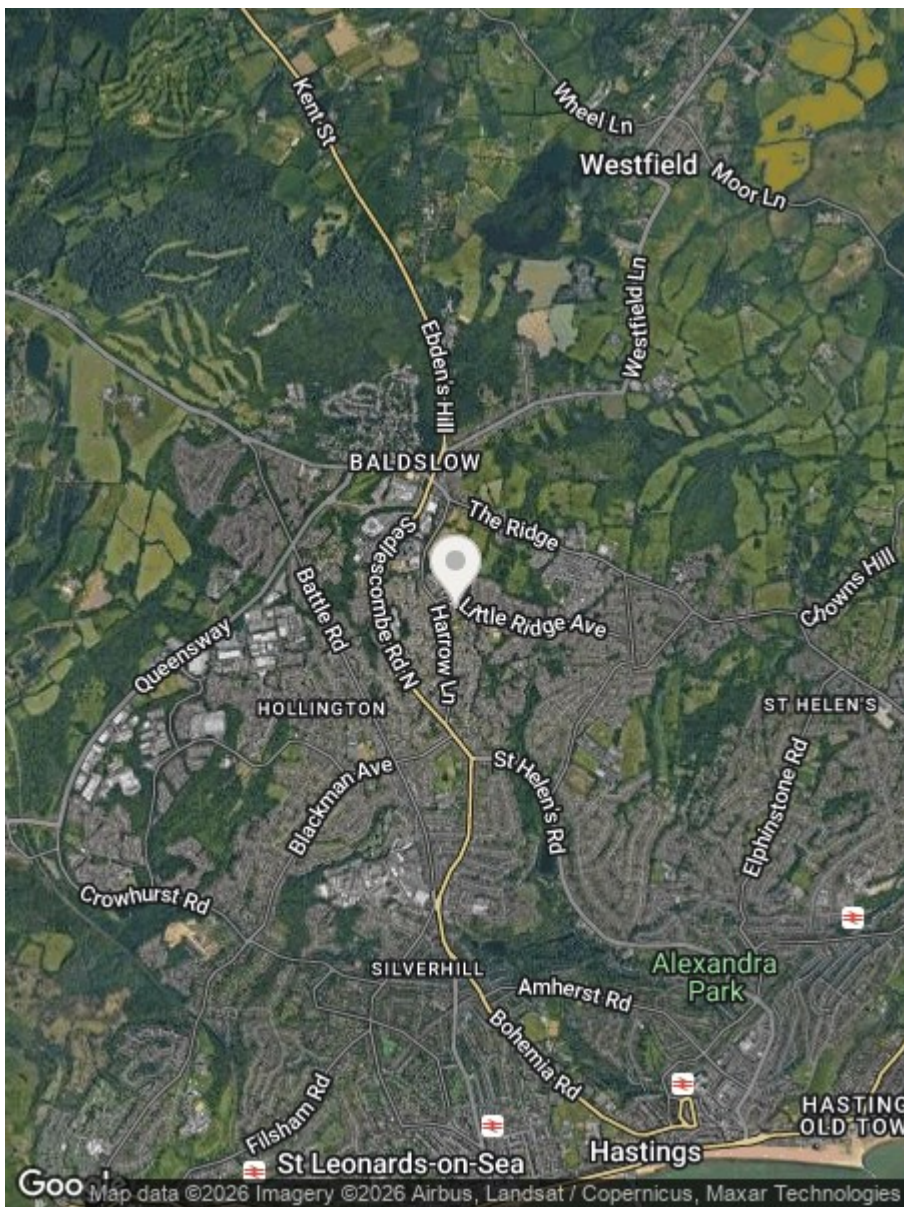

Energy Efficiency Rating		
	Current	Potential
Very energy efficient - lower running costs		
(92 plus) A		<div style="border: 1px solid black; padding: 2px; display: inline-block;">88</div>
(81-91) B		
(69-80) C		
(55-68) D		
(39-54) E		
(21-38) F		
(1-20) G		
Not energy efficient - higher running costs		
England & Wales	EU Directive 2002/91/EC	

Environmental Impact (CO ₂) Rating		
	Current	Potential
Very environmentally friendly - lower CO ₂ emissions		
(92 plus) A		
(81-91) B		
(69-80) C		
(55-68) D		
(39-54) E		
(21-38) F		
(1-20) G		
Not environmentally friendly - higher CO ₂ emissions		
England & Wales	EU Directive 2002/91/EC	

Council Tax Band - B

Fixtures and fittings: A list of the fitted carpets, curtains, light fittings and other items fixed to the property which are included in the sale (or may be available by separate negotiation) will be provided by the Seller's Solicitors.

Important Notice:

1. Particulars: These particulars are not an offer or contract, nor part of one. You should not rely on statements by Rush, Witt & Wilson in the particulars or by word of mouth or in writing ("information") as being factually accurate about the property, its condition or its value. Neither Rush, Witt & Wilson nor any joint agent has any authority to make any representations about the property, and accordingly any information given is entirely without responsibility on the part of the agents, seller(s) or lessor(s).
2. Photos, Videos etc: The photographs, property videos and virtual viewings etc. show only certain parts of the property as they appeared at the time they were taken. Areas, measurements and distances given are approximate only.
3. Regulations etc: Any reference to alterations to, or use of, any part of the property does not mean that any necessary planning, building regulations or other consent has been obtained. A buyer or lessee must find out by inspection or in other ways that these matters have been properly dealt with and that all information is correct.
4. VAT: The VAT position relating to the property may change without notice.
5. To find out how we process Personal Data, please refer to our Group Privacy Statement and other notices at <https://rushwittwilson.co.uk/privacy-policy>



Residential Estate Agents
Lettings & Property Management



Rother House Havelock Road
Hastings
East Sussex
TN34 1BP
Tel: 01424 442443
hastings@rushwittwilson.co.uk
www.rushwittwilson.co.uk